

# KA7171

## USB-PS/2 KVM Adapter Module with Local Console Quick Start Guide

KA7171 Front View

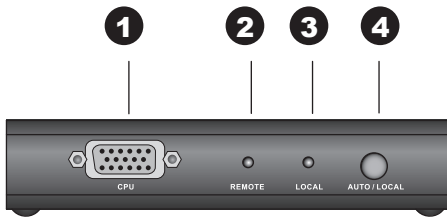

KA7171 Rear View

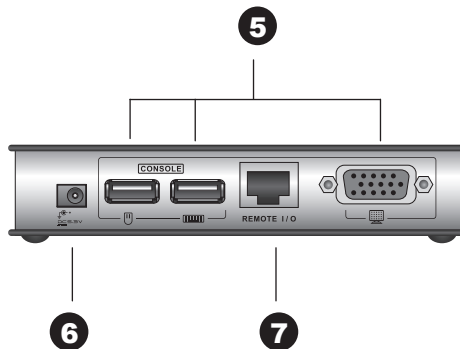

KA7171 Side View

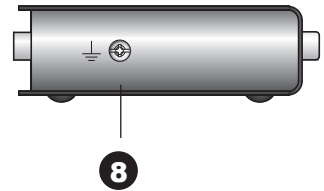

### Hardware

- |  |                       |
|--|-----------------------|
| 1. KVM Port                            | 5. Console Ports      |
| 2. Remote LED                          | 6. Power Jack         |
| 3. Local LED                           | 7. Remote I/O         |
| 4. Operating Mode Selection Pushbutton | 8. Grounding Terminal |

### Hardware Installation

#### Grounding

To prevent damage to your installation it is important that all devices are properly grounded.

1. Use a grounding wire to ground the KA7171 by connecting one end of the wire to the grounding terminal, and the other end of the wire to a suitable grounded object.
2. Make sure that the computer and the monitor that the KA7171 connects to are properly grounded.
3. For increased grounding protection, use STP (shielded twisted pair) cable to connect the Local console to the KVM switch. There are two methods that can be used:
  1. In addition to the eight paired wires, STP cable also contains a grounding wire. Solder this wire to the RJ-45 connector as shown here:
  2. The second method is to use the STP cable shielding for grounding. In this case, make sure that the shielding makes tight contact with the top inside of the RJ-45 connector as shown here:

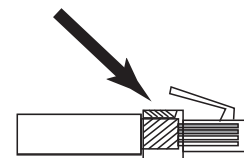
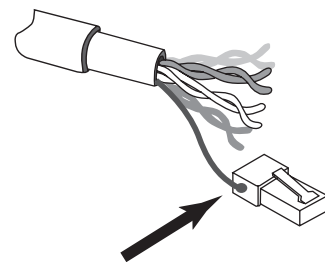
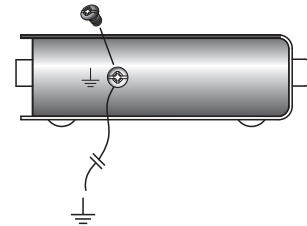

Make sure that the power to any device that you connect to the installation has been turned off. You must unplug the power cords of any computers that have the Keyboard Power On function.

## Connecting the Cables

1. Plug the cables from the local console devices (mouse, keyboard, monitor) into their ports on the Console section on the rear of the KA7171 Unit.
2. Plug the appropriate connectors on the USB-PS/2 KVM cable supplied with this unit into their ports on the KVM section on the front of the KA7171 Unit.
3. Plug the USB or PS/2 connectors on the other end of the KVM cable into the appropriate ports on the local computer.

**Warning!** Plugging both the PS/2 and USB connectors into the computer at the same time may cause the installation to malfunction.

4. Plug one end of the Cat 5e cable into the KA7171's I/O port. Plug the other end of the Cat 5e cable into the port of the KVM switch.
5. Plug the power adapter (supplied with this package) into an AC source; plug the adapter's power cable into the KA7171's Power Jack.
6. Power on the local PC

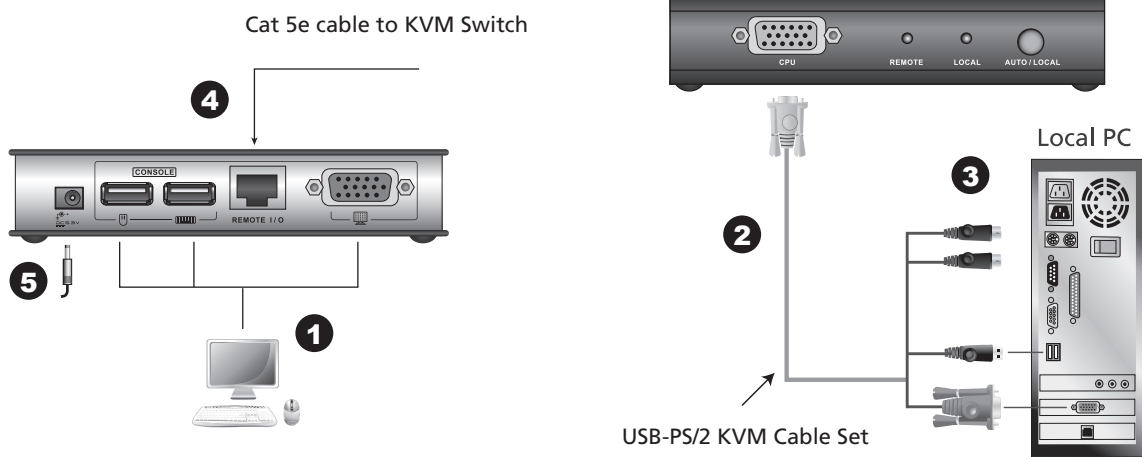

## Operating Modes

The KA7171 USB-PS/2 KVM Adapter Module with Local Console has three operating modes: Local, Auto, and Remote, as shown in the table, below:

Mode	Description
Local	Only the local console has KVM access. The remote console's keyboard and mouse input is disabled.
Auto	Both the local and remote consoles can have KVM access, but not at the same time. The local console will always have priority access over the remote console, meaning that anytime the local console is used the remote console will be disabled. The remote console will be able regain access once the local console is no longer being used.

**Note:** The default operating mode is Auto.

## LED Display

The KA7171 has two LEDs to indicate the operating status, as shown in the table, below:

LED	Indication
Local (Green)	Lights to indicate that the local console access is active.
Remote (Green)	Lights to indicate that the KA7171 link to the KVM switch is active. Flashing indicates that the KVM switch is sending/receiving data to/from the console.

### Online Registration

<http://eservice.aten.com>

### Technical Phone Support

**International:**  
886-2-86926959

**North America:**  
1-888-999-ATEN Ext: 4988

**United Kingdom:**  
44-8-4481-58923

All information, documentation, firmware, software utilities, and specifications contained in this package are subject to change without prior notification by the manufacturer. Please visit our website <http://www.aten.com/download/?cid=dds> for the most up-to-date versions.

© Copyright 2012 ATEN® International Co., Ltd.  
ATEN and the ATEN logo are trademarks of ATEN International Co., Ltd. All rights reserved. All other trademarks are the property of their respective owners.

This product is RoHS compliant.

Part No. PAPE-1215-H00G  
Printing Date: 12/2012

